



ICCC 2024

### On-Campus Accommodations

On-campus housing will be the closest option to the Lory Student Center, where the conference will be held. There will be two housing locations options for ICCC 2024 participants.

1. **Corbett Hall:** suite-style rooms with a shared bathroom between two rooms. All units have a bed, a desk, a shared bathroom with the connecting room, and a closet.
2. **Laurel Village Private Rooms:** has a mix of community-style and suite-style rooms with shared and private bathrooms. All units have AC, a bed, a desk, a bathroom (private or shared), and a closet.

| Hall Name      | Style           | Room Type                          | Bathroom Style                    | Price per night |
|----------------|-----------------|------------------------------------|-----------------------------------|-----------------|
| Corbett Hall   | Suite Style     | Single Room                        | shared bathroom between two rooms | \$ 76.50        |
| Corbett Hall   | Suite Style     | Double Room w/ Conference Roommate | shared bathroom between two rooms | \$ 50.00        |
| Corbett Hall   | Suite Style     | Double Room w/ Guest               | shared bathroom between two rooms | \$ 117.50       |
| Laurel Village | Community Style | Single Room                        | shared community bathroom         | \$ 78.50        |
| Laurel Village | Community Style | Double Room w/ Conference Roommate | shared community bathroom         | \$ 57.00        |
| Laurel Village | Community Style | Double Room w/ Guest               | shared community bathroom         | \$ 113.50       |
| Laurel Village | Private         | Single Room                        | private bathroom                  | \$ 90.50        |
| Laurel Village | Private         | Double Room w/ Conference Roommate | private bathroom                  | \$ 63.50        |
| Laurel Village | Private         | Double Room w/ Guest               | private bathroom                  | \$ 125.50       |
| Laurel Village | Private         | Family Room (Quad Room)            | private bathroom                  | \$ 230.50       |

3. **Additional Information:**

- a. Check-in as early as Saturday, July 27, 2024
- b. Check-out by Friday, August 2, 2024, for Suite and Community Style Rooms
- c. Check-out by Saturday, August 3, 2024, for a **limited number of Private Rooms and Community Style Rooms**
- d. Parking is included for conference lots (license plate required at check-in)
- e. Overnight housing includes breakfast the following morning at the Dining Center.
- f. Lodging includes all linens including sheets, towels, a pillow, and a blanket. Fresh linens are available at the front desk if you need extra towels, blankets, etc.
- g. A refrigerator is available in the common access area of your building.
- h. Bring all your own toiletry items as none are provided at the residence hall. This includes shampoo, conditioner, hand soap, and hair dryers. Additionally, hangers and alarm clocks are not provided in the residence halls.
- i. No alcohol, marijuana, tobacco, or animals are allowed at Colorado State University, including in the on-campus housing.

## Corbett Floorplan:

1 or 2 people per room with a shared bathroom between 2 rooms



## Laurel Village Community Style Double:

## Laurel Village Private Double:



**Laurel Village Community Style Single:**

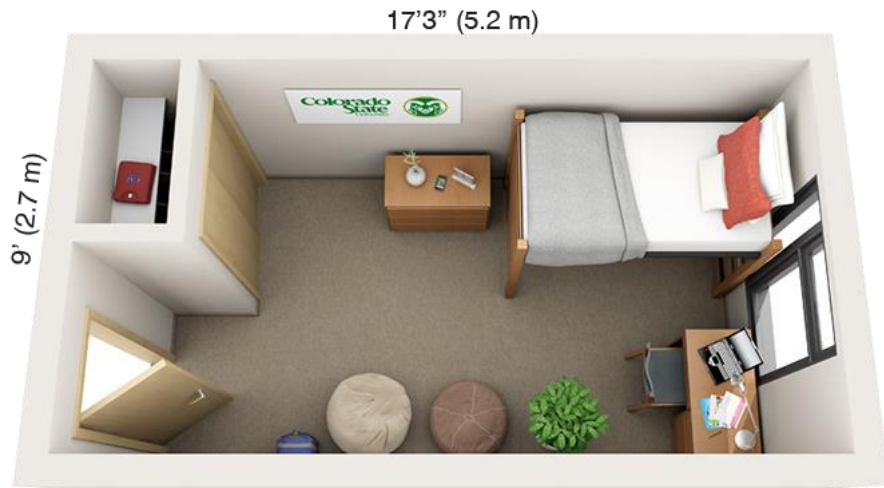

**Laurel Village Private Single:**

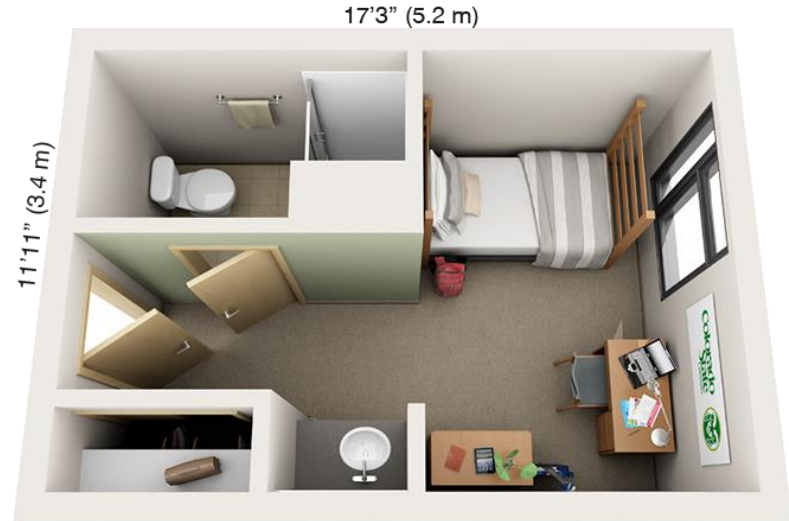

**Laurel Village Community Style Bathrooms:**

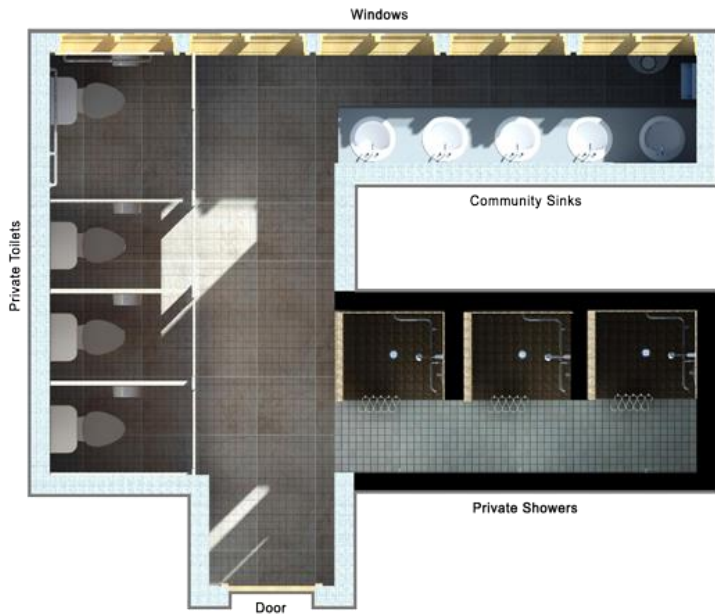

**Laurel Village Family Room (Quad Room):**

